

TermoVana

VITRE 7.5

WOOD



Foyer en vermiculite haute densité



Sortie supérieure des fumées

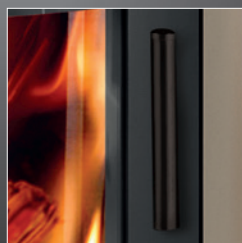

Poignée anti-brûlure

WOOD
VITRE 7.5



★★★★★
Prodotto conforme alla Classe 4 Stelle secondo i requisiti di emissioni e rendimento del Decreto 7 Novembre 2017, n. 186



VITRE 7.5

Classe energetica	A+
Conformità	EN 13240:2001 - CEN/TS 15883
Dimensioni	L 51 x P 41,2 x H 112 cm
Peso stufa	kg 121
Potenza termica nominale	kW 7,15
Rendimento potenza %	kW 78,4 %
Emissioni di CO	0,08 %
Diametro scarico fumi	Ø 150 mm
Consumo	2,146 kg / h
Volume riscaldabile	189 m ³
Combustibile legna	L 25 / 33 cm

PLUS

- Uscita fumi superiore
- Vetro ceramico
- Porta panoramica
- Focolare in vermiculite alta densità
- Regolazione aria comburente
- Cassetto cenere
- Vano porta legna
- Prelievo aria comburente dall'esterno

FINITURE



Metallo Rosso opaco



Metallo Nero opaco



Metallo Tortora opaco

OPTIONAL

DIMENSIONI

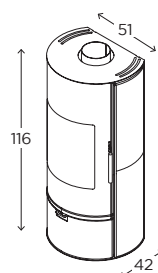

VITRE 7.5

WOOD

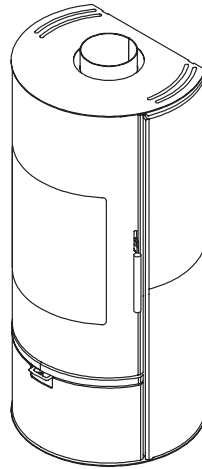
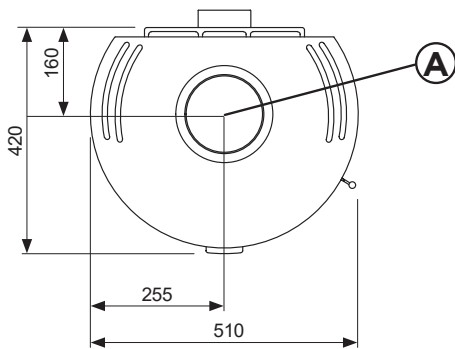
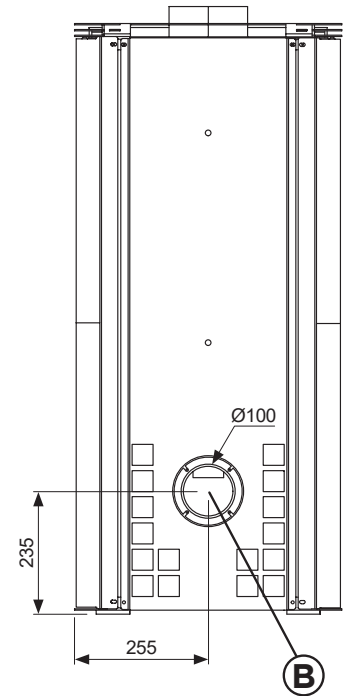
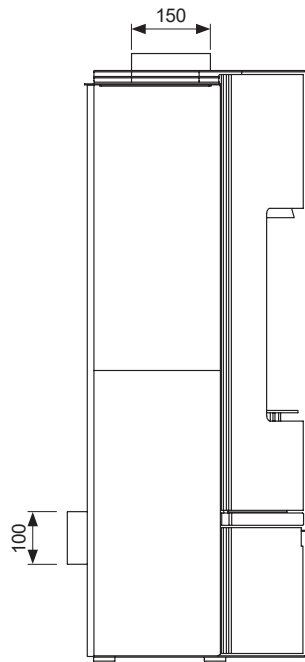
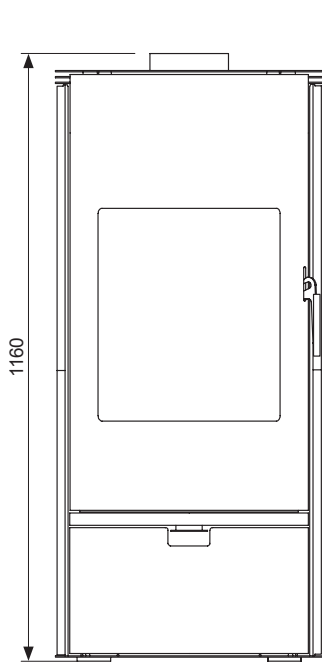

Sortie des fumées	A
Entrée d'air comburant	B
Sortie de canalisation	-
Canalisable jusqu'à mètres linéaires (consulter le manuel pour une correcte installation)	-